



FASTEKS[®] slepe zakovice
FASTEKS[®] Blind rivets

FASTEKS® slepe zakovice

Zakovice pouzdano povezuju dva nezavisna dela materijala. Bilo da se radi o čeliku, plastici ili drugim materijalima različitih jačina i debljina, zakovice će se pobrinuti za bezbedno držanje. Čak i veće komponente mogu trajno da se povezuju, bez ikakvih izobličenja i oštećivanja površine.

Više od FASTEKS®

www.kvt-fastening.de/en/products/brands/fasteks/

FASTEKS® Blind Rivets

Rivets connect reliable two parts independent to the materials. Whether steel, plastics or other materials with different strengthes and material thicknesses, the rivets take care of save hold. Even bigger components can be durable connected free from distortion and without surface damage.

More about FASTEKS®

www.kvt-fastening.de/en/products/brands/fasteks/



Sadržaj Content

Standardne zakovice sa kupastom glavom, kojima se lomi stablo Standard break stem rivets, domed head Nerđajući čelik galvanizovani čelik aluminijum, 3,5 % / 2,5 % magnezijum Stainless steel steel galvanized aluminum, 3.5 % / 2.5 % magnesium	4 – 6
Standardne zakovice sa upuštenom glavom, kojima se lomi stablo Standard break stem rivets, countersunk Galvanizovani čelik aluminijum, 3,5 % magnezijum Steel galvanized aluminum, 3.5 % magnesium	7 – 8
Multigrip zakovice sa kupastom glavom Multigrip rivets, domed head Galvanizovani čelik aluminijum, 2,5 % magnezijum Steel galvanized aluminum, 2.5 % magnesium	9 – 10
Multigrip zakovice sa upuštenom glavom Multigrip rivets, countersunk Aluminijum, 2,5 % magnezijum Aluminum, 2.5 % magnesium	11
Zakovice sa kupastom glavom, sa zatvorenim krajem Closed end rivets, domed head Nerđajući čelik galvanizovani čelik aluminijum, 5 % magnezijum Stainless steel steel galvanized aluminum, 5 % magnesium	12 – 14

Pre početka serijske proizvodnje neophodno je da se posebno provere tehničke karakteristike, preporuke za instalaciju, kao i nespecificirane tolerancije u pogledu dimenzija delova.

Sve dimenzije su navedene u mm.

Technical performances, installation recommendations as well as unspecified tolerances regarding the dimensions of the parts have to be requested individual for each application before starting the series production.

All dimensions are specified in mm.

Standardne zakovice kojima se lomi stablo

Standard break stem rivets

Kupasta glava | Domed head

Materijal

Telo: Nerđajući čelik
Klin: Nerđajući čelik





Dodatni tipovi na zahtev

Material

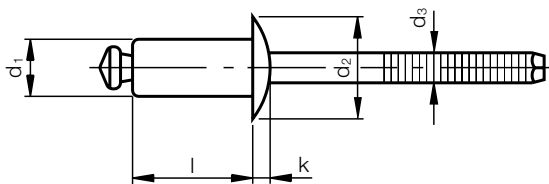
Body: Stainless steel
Mandrel: Stainless steel

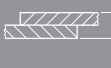
Additional types on request



d_1 -0,15 +0,08	l +1,0 -0,5			k $\pm 0,4$	d_2 $\pm 1,0$	d_3 nom.			Opis naloga Order description
3,2	6,0	1,5 - 2,5	3,3	0,8	6,5	2,0	1800	2500	KSD 3206 SSA2
	8,0	2,5 - 4,5							KSD 3208 SSA2
	10,0	4,5 - 6,5							KSD 3210 SSA2
4,0	6,0	0,5 - 2,0	4,1	1,0	8,0	2,5	2900	3600	KSD 4006 SSA2
	8,0	2,0 - 4,0							KSD 4008 SSA2
	10,0	4,0 - 6,0							KSD 4010 SSA2
	13,0	7,0 - 9,0							KSD 4013 SSA2
4,8	8,0	1,5 - 3,0	4,9	1,1	9,5	2,9	4200	5300	KSD 4808 SSA2
	10,0	3,0 - 5,0							KSD 4810 SSA2

Standardne zakovice kojima se lomi stablo

Standard break stem rivets

Kupasta glava | Domed head

Materijal

Telo: Galvanizovani čelik
Klin: Galvanizovani čelik





Material

Body: Steel galvanized
Mandrel: Steel galvanized

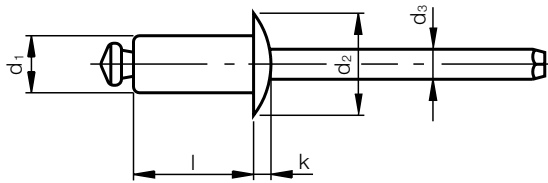
Dodatni tipovi na zahtev

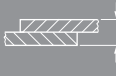
Additional types on request



d_1 -0,15 +0,08	l +1,0 -0,5			k $\pm 0,4$	d_2 $\pm 1,0$	d_3 nom.			Opis naloga Order description
3,2	6,0	1,5 – 3,0	3,3	0,8	6,5	2,0	1060	1285	KSD 3206 STST
	8,0	3,0 – 5,0							KSD 3208 STST
	10,0	5,0 – 7,0							KSD 3210 STST
4,0	6,0	1,5 – 2,5	4,1	1,0	8,0	2,5	1550	1990	KSD 4006 STST
	8,0	2,5 – 4,5							KSD 4008 STST
	10,0	4,5 – 6,5							KSD 4010 STST
4,8	8,0	2,5 – 4,5	4,9	1,1	9,5	2,9	2300	2920	KSD 4808 STST
	10,0	4,5 – 6,0							KSD 4810 STST
	12,0	6,0 – 8,0							KSD 4812 STST
	14,0	8,0 – 10,0							KSD 4814 STST
	16,0	10,0 – 11,5							KSD 4816 STST
	18,0	11,5 – 13,5							KSD 4818 STST

Standardne zakovice kojima se lomi stablo

Standard break stem rivets

Kupasta glava | Domed head

Materijal

Telo: Aluminijum, 3,5 % / 2,5 % magnezijum
Klin: Galvanizovani čelik

Material

Body: Aluminum, 3.5% / 2.5% magnesium
Mandrel: Steel galvanized

Dodatni tipovi na zahtev

Additional types on request

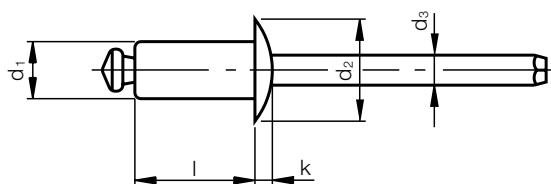

d_1 -0,15 +0,08	l +1,0 -0,5			k $\pm 0,4$	d_2 $\pm 1,0$	d_3 nom.			Opis naloga Order description
3,2	4,0	0,5 - 1,5	3,3	0,8	6,5	1,75	670	980	KSD 3204 ALST
	6,0	1,5 - 3,5							KSD 3206 ALST
	8,0	3,5 - 5,5							KSD 3208 ALST
	10,0	5,5 - 7,5							KSD 3210 ALST
	12,0	7,5 - 9,5							KSD 3212 ALST
	14,0	9,5 - 11,5							KSD 3214 ALST
4,0	6,0	1,5 - 3,0	4,1	1,0	8,0	2,10	1050	1560	KSD 4006 ALST
	8,0	3,0 - 5,0							KSD 4008 ALST
	10,0	5,0 - 6,5							KSD 4010 ALST
	12,0	6,5 - 8,5							KSD 4012 ALST
	14,0	8,5 - 10,5							KSD 4014 ALST
	16,0	10,5 - 12,5							KSD 4016 ALST
4,8	8,0	3,0 - 4,5	4,9	1,1	9,5	2,70	1690	2230	KSD 4808 ALST
	10,0	4,5 - 6,0							KSD 4810 ALST
	12,0	6,0 - 8,0							KSD 4812 ALST
	14,0	8,0 - 10,0							KSD 4814 ALST
	16,0	10,0 - 12,0							KSD 4816 ALST
	18,0	12,0 - 14,0							KSD 4818 ALST
20,0	14,0 - 16,0	KSD 4820 ALST							

Standardne zakovice kojima se lomi stablo

Standard break stem rivets

Upuštena glava | Countersunk

Materijal

Telo: Galvanizovani čelik
Klin: Galvanizovani čelik





Material

Body: Steel galvanized
Mandrel: Steel galvanized

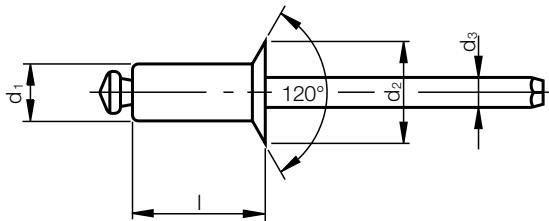
Dodatni tipovi na zahtev

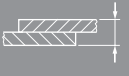
Additional types on request



d_1 -0,15 +0,08	l +1,0 -0,5			d_2 $\pm 0,5$	d_3 nom.			Opis naloga Order description
						N	N	
3,2	8,0	3,0 – 5,0	3,3	6,0	2,0	1060	1285	KSK 3208 STST
4,0	8,0	2,5 – 4,5	4,1	7,5	2,5	1550	1990	KSK 4008 STST
4,8	8,0	2,5 – 4,5	4,9	9,0	2,9	2300	2920	KSK 4808 STST
	10,0	4,5 – 6,0						KSK 4810 STST

Standardne zakovice kojima se lomi stablo

Standard break stem rivets

Upuštena glava | Countersunk

Materijal

Telo: Aluminijum, 3,5 % magnezijum
Klin: Galvanizovani čelik

Material

Body: Aluminum, 3.5% magnesium
Mandrel: Steel galvanized

Dodatni tipovi na zahtev

Additional types on request

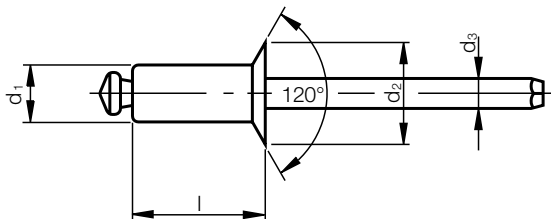

d_1 -0,15 +0,08	l +1,0 -0,5			d_2 $\pm 0,5$	d_3 nom.			Opis naloga Order description
						N	N	
3,2	8,0 10,0	3,5 - 5,5 5,5 - 7,5	3,3	6,0	1,75	760	980	KSK 3208 ALST KSK 3210 ALST
4,0	10,0	5,0 - 6,5	4,1	7,5	2,10	1050	1560	KSK 4010 ALST

Multigrip zakovice

Multigrip rivets

Kupasta glava | Domed head

Materijal

Telo: Galvanizovani čelik
Klin: Galvanizovani čelik

Material

Body: Steel galvanized
Mandrel: Steel galvanized

Dodatni tipovi na zahtev

Additional types on request

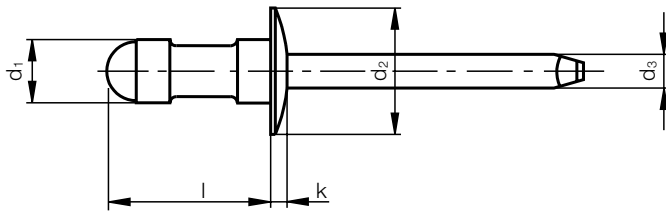

d_1 -0,15 +0,08	l +1,0 -0,5			k maks.	d_2 $\pm 0,4$	d_3 nom.			Opis naloga Order description
3,2	9,0	1,5-4,0	3,3	1,1	7,2	2,1	1500	1700	KMD 3209 STST

Materijal

Telo: Aluminijum, 2,5 % magnezijum
Klin: Galvanizovani čelik

Material

Body: Aluminum, 2.5% magnesium
Mandrel: Steel galvanized

Dodatni tipovi na zahtev

Additional types on request

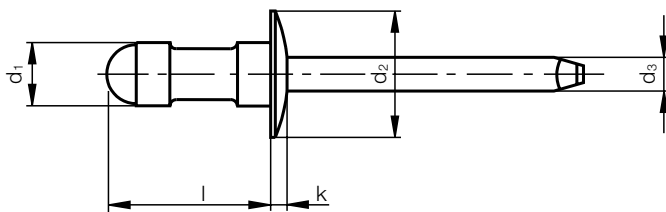

d_1 -0,15 +0,08	l +1,0 -0,5			k maks.	d_2 $\pm 0,4$	d_3 nom.			Opis naloga Order description
3,2	8,0	0,5-5,0	3,3-3,5	1,4	6,0	1,8	680	950	KMD 3208 ALST
	12,0	4,0-9,5							KMD 3212 ALST
4,0	10,0	1,5-6,5	4,1-4,3	1,7	8,0	2,2	950	1500	KMD 4010 ALST
	12,7	4,0-9,5							KMD 4013 ALST
	16,0	7,5-12,5							KMD 4016 ALST
4,8	12,0	2,0-7,0	4,9-5,2	2,0	9,5	2,8	1300	2000	KMD 4812 ALST
	16,0	6,0-11,0							KMD 4816 ALST

Multigrip zakovice

Multigrip rivets

Kupasta glava | Domed head

Materijal

Telo: Aluminijum, 2,5 % magnezijum
Klin: Nerđajući čelik

Material

Body: Aluminum, 2.5% magnesium
Mandrel: Stainless steel

Dodatni tipovi na zahtev

Additional types on request

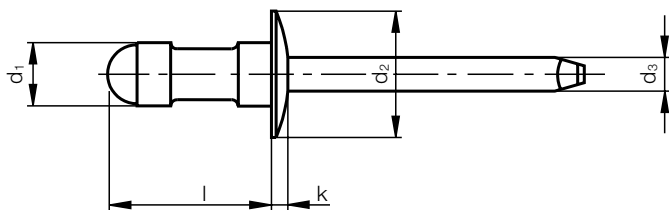

d_1 -0,15 +0,08	l +1,5 -0,5			k maks.	d_2 $\pm 0,4$	d_3 nom.			Opis naloga Order description
3,2	8,0	0,8 – 4,8	3,3 – 3,5	1,4	6,0	1,8	650	950	KMD 3208 ALSS
	11,0	4,0 – 7,9							KMD 3211 ALSS
4,0	9,0	1,2 – 6,0	4,1 – 4,3	1,7	8,0	2,2	950	1500	KMD 4009 ALSS
	12,0	4,0 – 9,5							KMD 4012 ALSS
4,8	10,3	1,6 – 5,5	4,9 – 5,2	2,0	9,5	2,7	1300	2000	KMD 4810 ALSS
	15,0	5,0 – 10,5							KMD 4815 ALSS

Multigrip zakovice

Multigrip rivets

Upuštena glava | Countersunk

Materijal

Telo: Aluminijum, 2,5 % magnezijum
Klin: Galvanizovani čelik

Material

Body: Aluminum, 2.5% magnesium
Mandrel: Steel galvanized

Dodatni tipovi na zahtev

Additional types on request

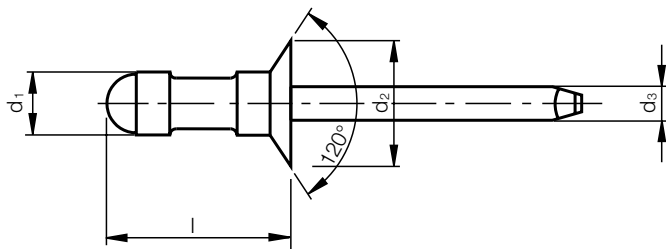

d_1 -0,15 +0,08	l +1,0 -0,5			d_2 $\pm 0,5$	d_3 nom.			Opis naloga Order description
4,8	12,0 16,0	2,0 – 7,0 6,0 – 11,0	4,9 – 5,2	9,5	2,78	1320	2000	KMK 4812 ALST KMK 4816 ALST

Zakovice sa zatvorenim krajem

Closed end rivets

Kupasta glava | Domed head

Materijal

Telo: Nerđajući čelik
Klin: Nerđajući čelik

Material

Body: Stainless steel
Mandrel: Stainless steel

Dodatni tipovi na zahtev

Additional types on request

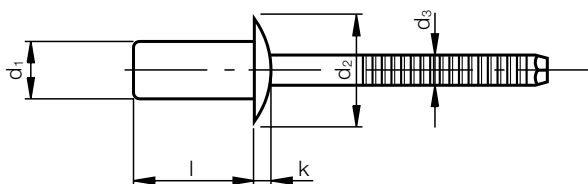

d_1 -0,15 +0,08	l +1,0 -0,5			k maks.	d_2 $\pm 1,0$	d_3 nom.	 N	 N	Opis naloga Order description
3,2	8,0	1,5 - 3,0	3,3	1,4	6,0	1,9	2000	2200	KCD 3208 SSA2
	9,5	3,0 - 5,0							KCD 3209 SSA2
	12,0	5,0 - 7,0							KCD 3212 SSA2
4,0	8,0	1,5 - 3,0	4,1	1,7	8,0	2,3	3000	3600	KCD 4008 SSA2
	9,5	3,0 - 5,0							KCD 4009 SSA2
	12,0	5,0 - 6,5							KCD 4012 SSA2
	16,0	6,5 - 10,5							KCD 4016 SSA2
4,8	9,5	3,0 - 5,0	4,9	2,0	9,5	2,9	4000	4400	KCD 4809 SSA2
	12,0	5,0 - 6,5							KCD 4812 SSA2

Zakovice sa zatvorenim krajem

Closed end rivets

Kupasta glava | Domed head

Materijal

Telo: Galvanizovani čelik
Klin: Galvanizovani čelik

Material

Body: Steel galvanized
Mandrel: Steel galvanized

Dodatni tipovi na zahtev

Additional types on request

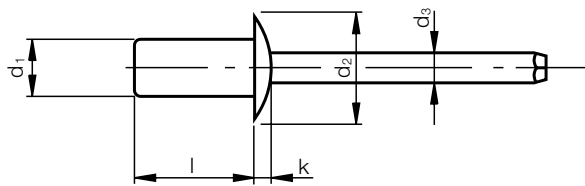

d_1 -0,15 +0,08	l +1,0 -0,5			k maks.	d_2 $\pm 1,0$	d_3 nom.			Opis naloga Order description
3,2	9,5	3,0-5,0	3,3	1,3	6,0	1,9	N	N	KCD 3209 STST
4,0	10,0	3,0-5,0	4,1	1,7	8,0	2,3	N	N	KCD 4010 STST
4,8	12,0	5,0-6,5	4,9	2,0	9,5	2,9	N	N	KCD 4812 STST

Zakovice sa zatvorenim krajem

Closed end rivets

Kupasta glava | Domed head

Materijal

Telo: Aluminijum, 5% magnezijum
Klin: Galvanizovani čelik

Material

Body: Aluminum, 5% magnesium
Mandrel: Steel galvanized

Dodatni tipovi na zahtev

Additional types on request

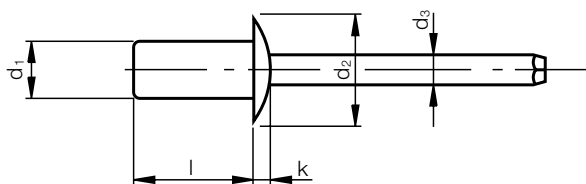

d_1 -0,15 +0,08	l +1,0 -0,5			k maks.	d_2 $\pm 1,0$	d_3 nom.			Opis naloga Order description
							N	N	
3,2	6,5	0,5 - 2,0	3,3	1,4	6,0	1,70	1070	1250	KCD 3206 ALST
	8,0	2,0 - 3,5							KCD 3208 ALST
	9,5	3,5 - 5,0							KCD 3209 ALST
	10,7	5,0 - 6,5							KCD 3210 ALST
4,0	8,0	0,5 - 3,5	4,1	1,7	8,0	2,18	1600	2200	KCD 4008 ALST
	9,5	3,5 - 4,5							KCD 4009 ALST
	11,0	4,5 - 6,5							KCD 4011 ALST
	12,7	6,5 - 8,0							KCD 4012 ALST
4,8	8,0	1,0 - 3,0	4,9	2,0	9,5	2,63	2200	3100	KCD 4808 ALST
	9,5	3,0 - 4,5							KCD 4809 ALST
	11,0	4,5 - 6,0							KCD 4811 ALST
	12,5	6,0 - 7,5							KCD 4812 ALST
	14,0	7,5 - 9,0							KCD 4814 ALST

KVT-Fastening – Tehnologija učvrščivanja

KVT-Fastening – Fastening technology



Slepe zakivne navrtke
Blind rivet nuts



Tehnologija slepih zakovica
Blind rivet technology



Ulošci sa navojem
Thread-inserts



Samodržeći učvršćivači
Self-clinching fasteners



Sistemi zavarivanja sa usadnim vijkom¹⁾
Stud welding systems¹⁾



Navrtke za brave
Lock nuts



Učvršćivači za spajanje
Bonding fasteners



Rešenja za pristup
Access solutions



Elementi za brzo učvršćivanje i klipovi
Quick fastening elements and clips



Brzi osigurači i opružni klipovi
Quick release pins and spring plungers



Lepkovi i zaptivne mase¹⁾
Adhesives and sealants¹⁾



Građevinski učvršćivači²⁾
Construction fasteners²⁾



Specijalni procesi²⁾
Special processes²⁾



Cilindri
Plugs



Pojačivači pritiska³⁾
Pressure intensifiers³⁾



Tehnologija ugradnje
Installation technology



Brzi konektori⁴⁾
Quick connectors⁴⁾



Logistički sistemi
Logistic systems



Razvoj rešenja
Solutioneering

Rešenja za složene primene učvršćivanja, zaptivanja i kontrole protoka

Prošireni KVT portfolio nudi optimalna rešenja za najzahtevnije primene.

Za više informacija o našem proizvodnom asortimanu i naručivanju u našoj elektronskoj prodavnici, posetite sajt www.kvt-fastening.com

Fastening, Sealing and Flow Control Solutions for complex Applications

The extensive KVT portfolio offers optimal solutions for your most challenging applications.

For more information about our range of products and order at our E-shop, please visit www.kvt-fastening.com

¹⁾ Nije dostupno u Nemačkoj. ²⁾ Dostupno samo u Švajcarskoj. ³⁾ Nije dostupno u Švajcarskoj. ⁴⁾ Nije dostupno u Austriji.

¹⁾ Not available in Germany. ²⁾ Only available in Switzerland. ³⁾ Not available in Switzerland. ⁴⁾ Not available in Austria.

KVT-Fastening AG

Dietikon/Cirih | Švajcarska
Tel: +41 44 743 33 33
info-CH@kvt-fastening.com
www.kvt-fastening.ch

KVT-Fastening GmbH

Illerrieden | Nemačka
Tel: +49 7306 782 - 0
info-DE@kvt-fastening.com
www.kvt-fastening.de

KVT-Fastening GmbH

Linc/Pichling | Austrija
Tel: +43 732 25 77 00
info-AT@kvt-fastening.com
www.kvt-fastening.at

KVT-Fastening Sp. z o.o.

Radom | Poljska
Tel: +48 58 762 17 80
info-PL@kvt-fastening.com
www.kvt-fastening.pl

KVT-Fastening S.R.L.

Bukureșt | Rumunija
Tel: +40 37 1381155
info-RO@kvt-fastening.com
www.kvt-fastening.ro

KVT-Fastening spol. s.r.o.

Bratislava | Slovačka
Tel: +421 9 11102510
info-SK@kvt-fastening.com
www.kvt-fastening.sk

KVT-Tehnika pritrjevanja d.o.o.

Ljubljana | Slovenija
Tel: +386 1 2808019
info-SI@kvt-fastening.com
www.kvt-fastening.si

KVT-Fastening s.r.o.

Brno | Češka Republika
Tel: +420 547 125200201
info-CZ@kvt-fastening.com
www.kvt-fastening.cz

KVT-Fastening Kft.

Budimpešta | Mađarska
Tel: +36 1 769 0925
info-HU@kvt-fastening.com
www.kvt-fastening.hu



www.kvt-fastening.com

